

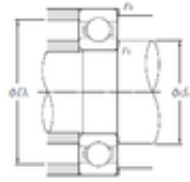

## China 6204 Bearing Supplier

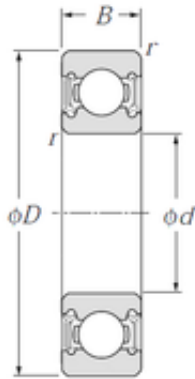

Japan bearing NTN 6204LLU Ball Bearing NTN 6204LLU/2ASU1 NTN 6204LU Ball bearing

Bearing No. 6204LLU

6204LLU Bearing 2D drawings and 3D CAD models

Size	20x47x14 mm
Bore Diameter	20 mm
Outer Diameter	47 mm
Width	14 mm
d	20 mm
D	47 mm
B	14 mm
C	14 mm
r min.	1 mm
da min.	25 mm
da max	28 mm
Da max.	42 mm
ra max.	1 mm
Weight	0,106 Kg
Basic dynamic load rating (C)	12,8 kN
Basic static load rating (C0)	6,65 kN
Reference speed	10 000 r/min
Category	Single Row Ball Bearings
Inventory	13.0
Manufacturer Name	NTN
Minimum Buy Quantity	N/A
Weight / Kilogram	0.103
EAN	4547359004540
Product Group	B00308
Enclosure	2 Seals



## China 6204 Bearing Supplier

Precision Class	ABEC 1   ISO P0
Maximum Capacity / Filling Slot	No
Rolling Element	Ball Bearing
Snap Ring	No
Internal Special Features	No
Cage Material	Steel
Enclosure Type	Contact Seal
Internal Clearance	C0-Medium
Inch - Metric	Metric
Long Description	20MM Bore; 47MM Outside Diameter; 14MM Outer Race Width; 2 Seals; Ball Bearing; ABEC 1   ISO P0; No Filling Slot; No Snap Ring; No Internal Special Features; C0-Medium Internal Clearance; Steel Cage;
Other Features	Deep Groove   Double Lip Friction Nitrile Rubber Seal   -20 To 120 Deg C
Category	Single Row Ball Bearing
UNSPSC	31171504
Harmonized Tariff Code	8482.10.50.68
Noun	Bearing
Keyword String	Ball
Manufacturer URL	<a href="http://www.ntnamerica.com">http://www.ntnamerica.com</a>
Manufacturer Item Number	6204LLU
Weight / LBS	0.227
Bore	0.787 Inch   20 Millimeter
Inner Race Width	0 Inch   0 Millimeter
Outside Diameter	1.85 Inch   47 Millimeter
Outer Race Width	0.551 Inch   14 Millimeter
bore diameter:	20 mm



## China 6204 Bearing Supplier

precision rating:	ISO Class 0
outside diameter:	47 mm
finish/coating:	Uncoated
overall width:	14 mm
bearing material:	High Carbon Chrome Steel
bore type:	Round
cage material:	Steel
closure type:	Double Sealed
inner ring width:	14 mm
row type & fill slot:	Single Row Non-Fill Slot
outer ring width:	14 mm
snap ring included:	Without Snap Ring
maximum rpm (grease):	10000 rpm
internal clearance:	CN
fillet radius:	1 mm
operating temperature range:	-40 to 120 ° C
maximum rpm:	18000 RPM
dynamic load capacity:	12800 N
series:	62
static load capacity:	6650 N
manufacturer product page:	<a href="#">Click here</a>